



Prepared By:  
City of Box Elder  
420 Villa Drive  
Box Elder, SD 57719  
(605) 923-1404

**CITY OF BOX ELDER**

**MEADE COUNTY**

**STATE OF SOUTH DAKOTA**

**RESOLUTION NO. 24-24**

**A RESOLUTION TO APPROVE A PETITION FOR ANNEXATION OF LOTS 2R, 3, AND 4 OF BIG B'S  
SUBDIVISION TO THE CITY OF BOX ELDER, MEADE COUNTY, SOUTH DAKOTA**

**WHEREAS**, the City of Box Elder has received a written petition for voluntary annexation signed by not less than three-fourths of the registered voters and by the owners of not less than three-fourths of the value of the territory sought to be annexed to the municipality; and

**WHEREAS**, certain territory, hereinafter more particularly described, is contiguous to the City of Box Elder, South Dakota; and

**WHEREAS**, the Common Council of the City of Box Elder deems that said area be annexed to the municipality as requested.

Lot 3 of Big B's Subdivision as part of the General Commercial Zoning District; and

Portions of Lot 2 of Big B's Subdivision to be known in future as Lots 2R and 4 of Big B's Subdivision as part of the General Residential 1 Zoning District.

**NOW, THEREFORE, BE IT RESOLVED** by the **Common Council of the City of Box Elder**, that the boundaries of said City of Box Elder, South Dakota, be and they hereby are extended to include the area contiguous to the City of Box Elder, described as follows:

Lot 3 of Big B's Subdivision as part of the General Commercial Zoning District; and,

Lots 2R and 4 of Big B's Subdivision, and adjacent Tower Road right-of-way, Section 8, T2N, R9E, B.H.M., Meade County, South Dakota, as part of the General Residential 1 Zoning District.

**PASSED, APPROVED AND ADOPTED** this 12<sup>th</sup> day of November, 2024.

*Larry Larson*

\_\_\_\_\_  
Larry Larson, Mayor

ATTEST:

*Renee Baker*

\_\_\_\_\_  
Renee Baker, Finance Officer



ATTESTATION

I, Chaz Kokesh, the City Clerk of the City of Box Elder, South Dakota, do hereby attest and state the above resolution was published on November 19, 2024 in the manner required by law and that all procedures required by the State of South Dakota law were complied with. This resolution shall become effective on the twentieth day after its publication, that date being: December 9, 2024.

*Chaz Kokesh*

\_\_\_\_\_  
Chaz Kokesh, City Clerk



CITY OF BOX ELDER RESOLUTION NO. 24-24 EXHIBIT

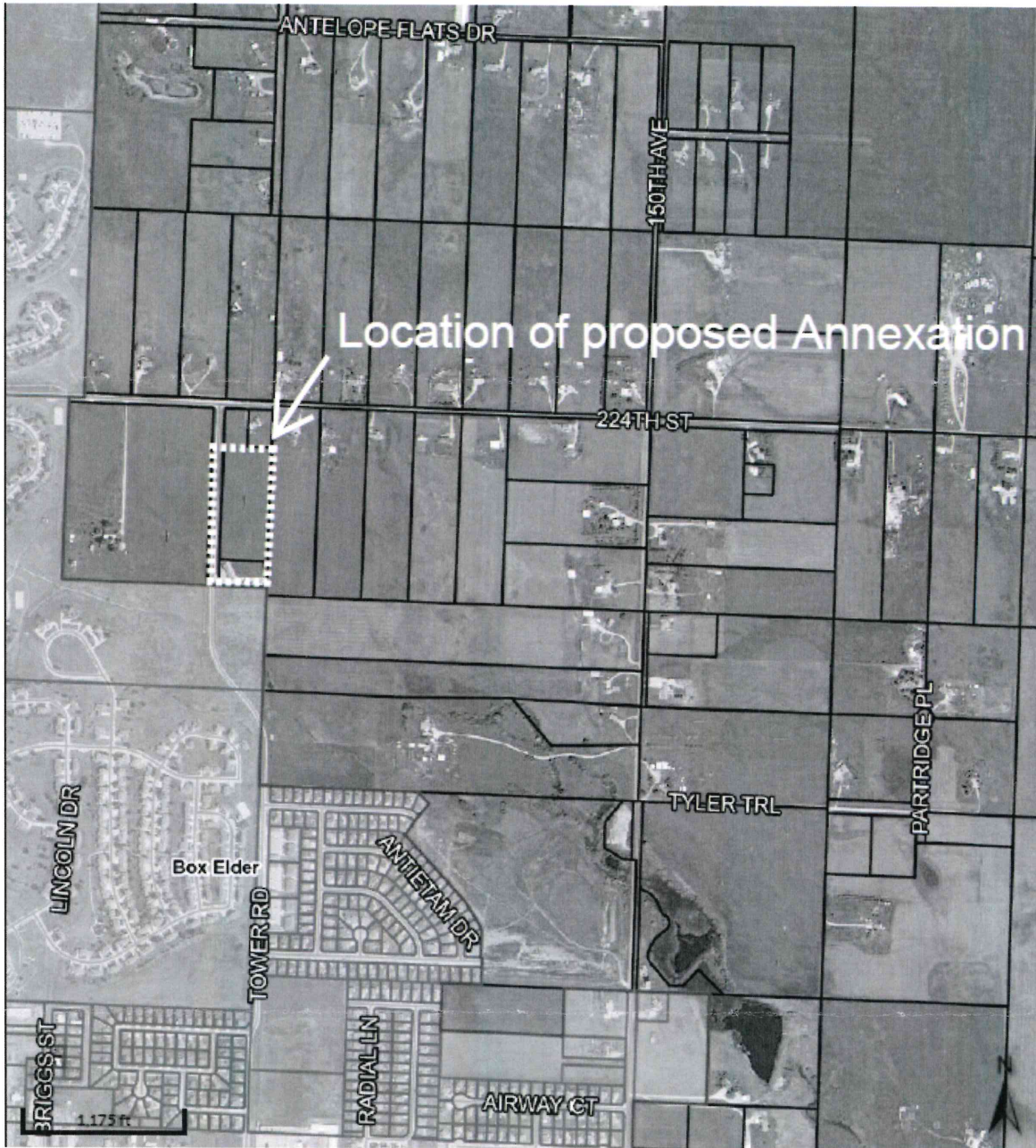

Annexation Location:

Parcel ID: 32.80.03 & Portions of 32.80.02

Legally Described as: Lot 3 of Big B's Subdivision, Portions of Lot 2 of Big B's Subdivision to be known in future as Lots 2R and 4 of Big B's Subdivision, and adjacent Tower Road right-of-way, Section 8, T2N, R9E, B.H.M., Meade County, South Dakota.